

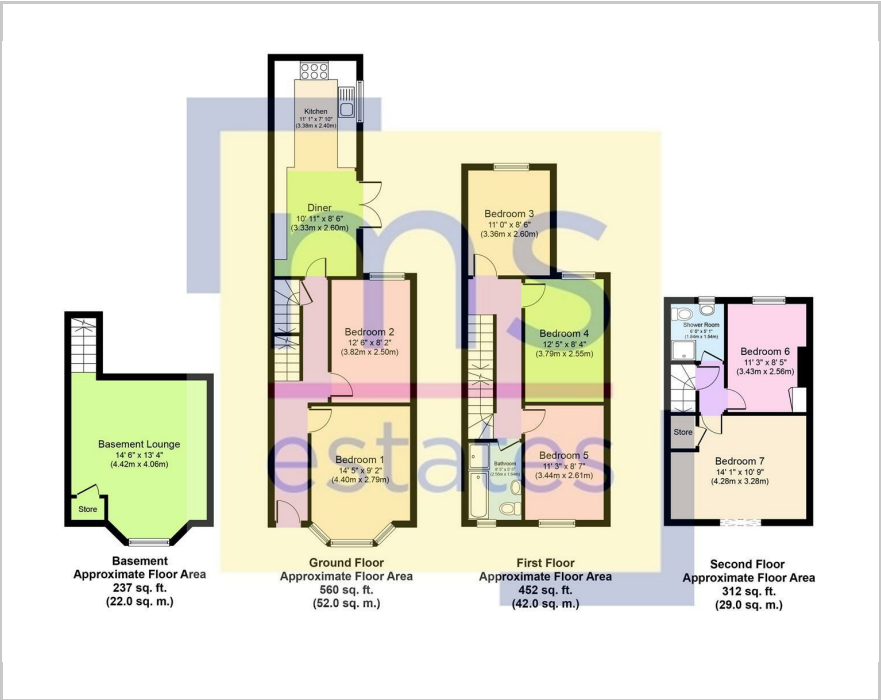

93 Kimbolton Avenue, Nottingham, NG7 1PS

£875 Per Week

Floor Plan



Area Map



- STUDENT ACCOMMODATION
- Utility bills included
- 7 Double bedrooms
- 2 Bathrooms
- Large basement lounge with TV
- Large open-plan kitchen/dining area
- Modern kitchen with dishwasher
- Located within the Lenton Triangle
- Close to local amenities

Energy Efficiency Rating		
	Current	Potential
Very energy efficient - lower running costs		
(92 plus) A		
(81-91) B		
(69-80) C		
(55-68) D		
(39-54) E		
(21-38) F		
(1-20) G		
Not energy efficient - higher running costs		
England & Wales	EU Directive 2002/91/EC	



These particulars, whilst believed to be accurate are set out as a general outline only for guidance and do not constitute any part of an offer or contract. Intending purchasers should not rely on them as statements of representation of fact, but must satisfy themselves by inspection or otherwise as to their accuracy. No person in this firm's employment has the authority to make or give any representation or warranty in respect of the property.